

REVISION CHANGES:

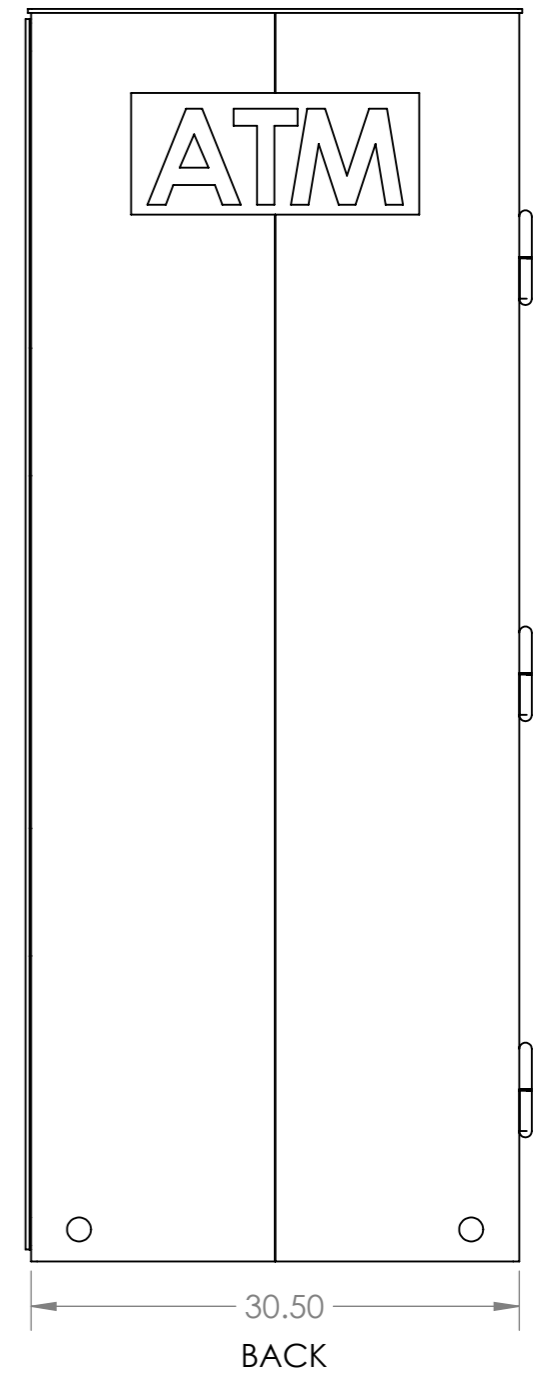
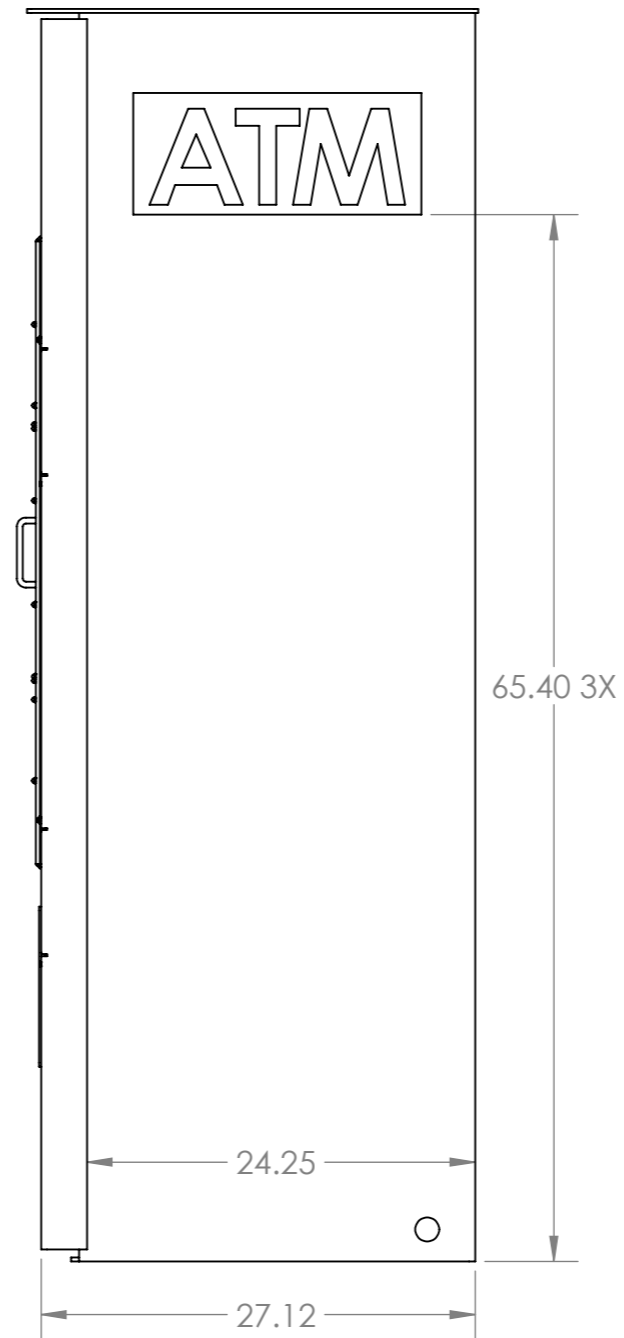
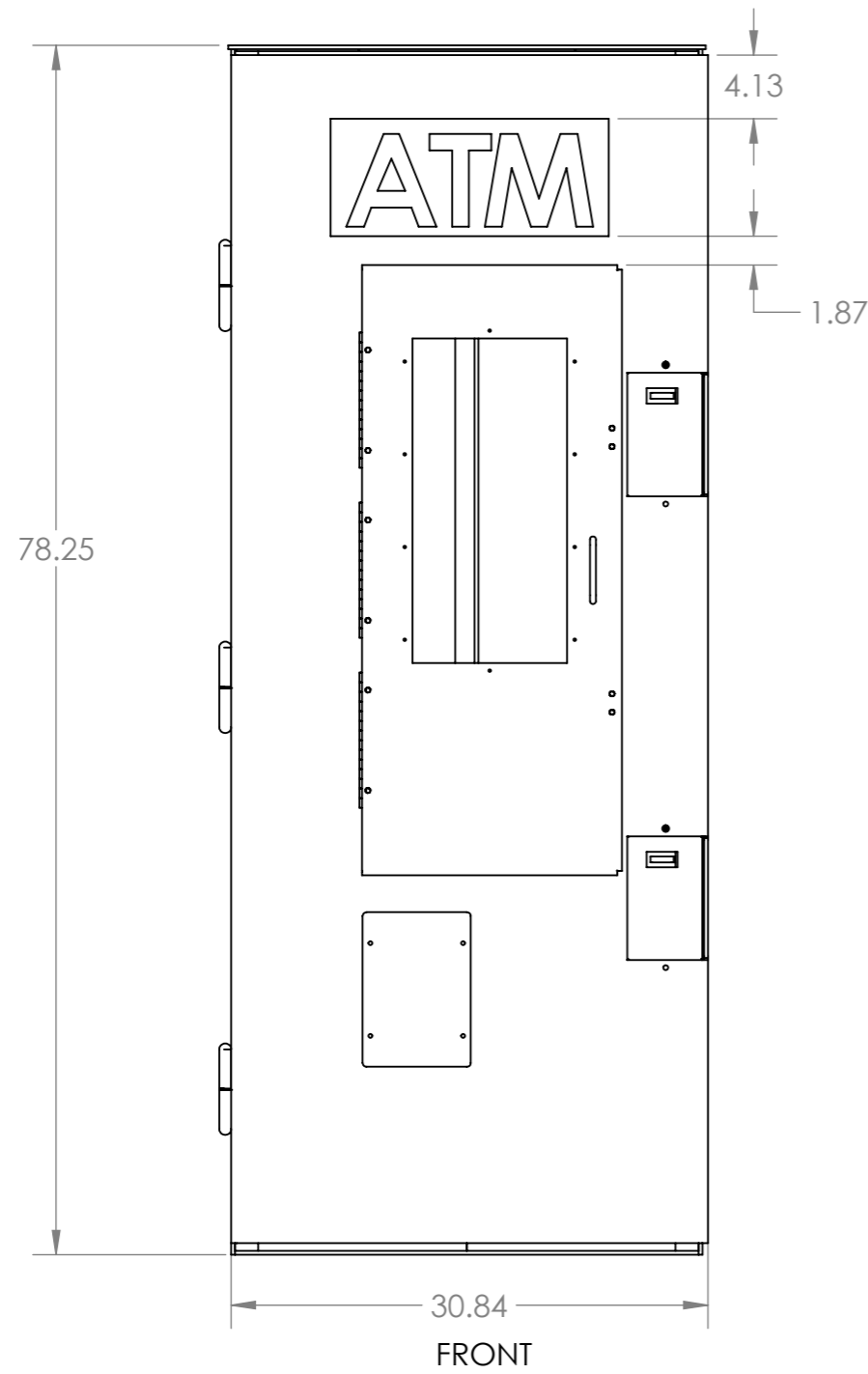

LAST SAVED DATE: 10/5/2018

<small>UNLESS OTHERWISE SPECIFIED: DIMENSIONS ARE IN INCHES SURFACE FINISH: TOLERANCES: 3 PLC ±.005 LINEAR: 2 PLC ±.010 ANGULAR: ±1°</small>				<small>FINISH:</small> PAINT		<small>DEBUR AND BREAK SHARP EDGES</small>		TPI 972-276-2901 FAX 972-276-3451 1136 N. FIRST ST. GARLAND, TX. 75040 www.tpitexas.com	
<small>DRAWN</small>	<small>NAME</small>	<small>SIGNATURE</small>	<small>DATE</small>			<small>TITLE:</small>			
<small>CHK'D</small>						ATM/ODU-GK1500 ODU HD UNIVERSAL ENCLOSURE			
<small>APPV'D</small>						<small>DO NOT SCALE DRAWING</small>			
<small>MFG</small>						<small>SCALE:1:12</small>			
<small>Q.A</small>						<small>MATERIAL:</small>			
						<small>WEIGHT:</small>			
						<small>DWG NO.</small>	ODU-GK1500 ATM Enclosure Dimension		A3
						<small>SHEET 1 OF 1</small>		<small>REVISION -</small>	